

1406 LOCHLIN TRAIL

GARDEN
STORAGE
12' X 12'

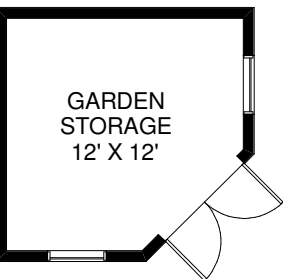

GARAGE
21' X 19'
APPROXIMATELY

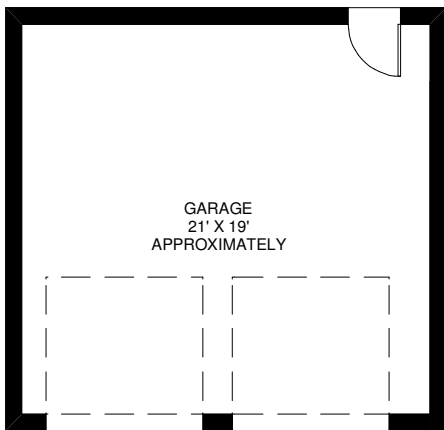

LIVING/ DINING
ROOM
23'5" X 13'2"

WALK OUT TO
PATIO

WALK OUT TO
PATIO

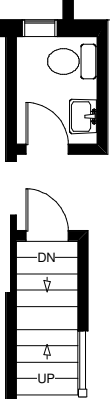

BREAKFAST
AREA
16'4" X 10'9"

SKYLIGHT CEILING

KITCHEN
14'3" X 9'

DEN / FAMILY
ROOM
13'3" X 11'9"

ENTRY
6' X 5'6"

MAIN FLOOR
APPROXIMATELY 1,100 SQ FT

PRIMARY
BEDROOM
20'9" X 15'8"

WALK IN
CLOSET

ENSUITE

BEDROOM
17' X 13'5"

BEDROOM
13'9" X 13'9"

SECOND FLOOR
APPROXIMATELY 1,160 SQ FT

UTILITY/
STORAGE
13' X 9'4"

FURNACE

LAUNDRY
19' X 9'4"

SHELVING
SHELVING

OFFICE/
POTENTIAL 4TH
BEDROOM
13'5" X 13'

BUILT INS / DESK

RECREATION ROOM
18'6" X 13'

STRG
UP

COLD
STORAGE
5' X 4'

LOWER FLOOR
APPROXIMATELY 900 SQ FT